

THIS COPY AND ANY REVISIONS BY IT OR ANY OTHER INSTRUMENT OF REFERENCE  
 DISTRICT COUNCIL PURSUANT TO SECTION 41 OF THE COPYRIGHT DESIGNERS  
 AND PATENTERS ACT 1988, UNLESS THAT ANY PROVISIONS IN RELEVANT  
 INSTRUMENTS TO COPYRIGHT, THE COPY MUST NOT BE COPIED, REPRODUCED  
 OR IN ANY MANNER COMMUNICATED TO THE PUBLIC WITHOUT THE WRITTEN  
 PERMISSION OF THE COPYRIGHT OWNER.

REVISED  
 20.06.17

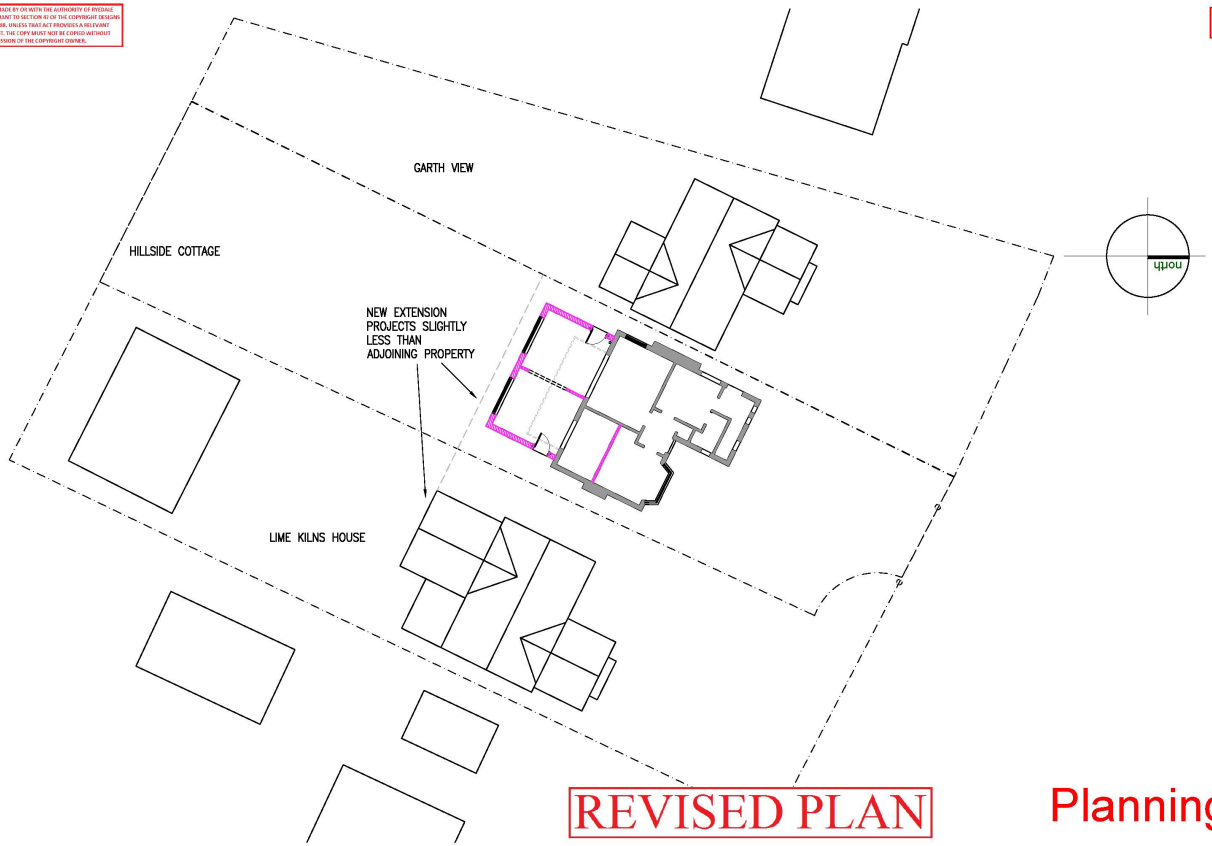

**REVISED PLAN**

**Planning**

Nicholas W Greenhalgh Dip Arch. R.I.B.A.  
 Chartered Architect Cedar Studio Designs Limited  
 42 Town St, Old Malton Malton N. Yorks. YO17 7HD  
 Tel. 01653 633657 07710 882456 Mobile



DO NOT SCALE FROM THIS DRAWING. IF IN DOUBT PLEASE ASK  
 ALL DIMENSIONS MUST BE CHECKED ON SITE WHERE POSSIBLE  
 THIS DRAWING MUST NOT BE REPRODUCED IN WHOLE OR PART WITHOUT  
 WRITTEN AUTHORITY

C Extension reduced 19-06-2017  
 B Lime Kilns House location corrected 04-04-2017  
 A Extension reduced 07-02-2017

client Mr & Mrs Ian Parker & Mrs Lucy Arekhi  
 project Hillside Cottage, Broughton Road, Malton  
 title Planning Proposals (Site Plan)  
 job ref 16/P20/P/03C scale 1:200 © A3

© A3